

TE-67MB-600 Mounting Kit

Installation

Parts Included

- mounting base for U.S. wallbox or surface mounting
- No. 6-32 x 7/8 in. oval-head screw (2)
- No. 4-40 x 1/4 in. hex-head cover screw
- drywall clip mounting kit (includes two each No. 6-20 x 1.25 in. pan-head tapping screws, spring clips, and spacers)

Wallbox Mounting: Special Tools Needed

- 1/16 in. (1.5 mm) Allen wrench or T-4000-119 Allen-head adjustment tool

To mount to a wallbox:

1. Pull the cable or wiring through the wallbox and base.
2. Rotate the mounting base, so one of the arrows on the base points up.
3. Fasten the base to the wallbox with the No. 6 screws provided. (See Figure 1.)

Note: These instructions assume a standard 2 x 4 in. (52 x 104 mm) U.S. wallbox is used.

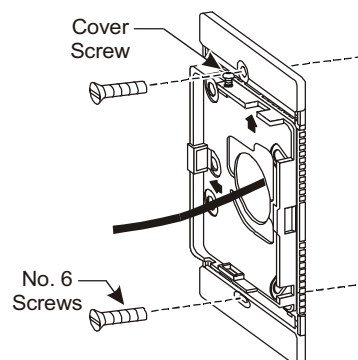

Figure 1: Wallbox Mounting

4. Place the bottom edge of the cover against the bottom lip of the base, and rotate it up onto the base as shown in Figure 2.
5. Tighten the cover screw.

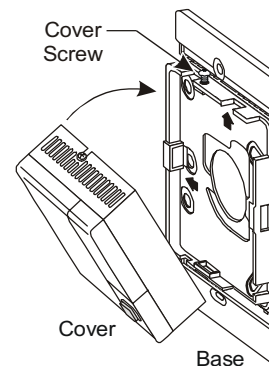

Figure 2: Attaching the Cover to the Base

IMPORTANT: Seal the drilled hole or use an ACC-INSL-0 Foam Pad Kit to help reduce drafts entering the unit. Drafts could result in false temperature readings.

Surface Mounting: Special Tools Needed

- hole saw with 1-3/8 in. (35 mm) diameter blade
- 1/16 in. (1.5 mm) Allen wrench or T-4000-119 Allen-head adjustment tool
- drill with 1/8 in. (3 mm) drill bit

To mount to drywall, refer to Figure 4 and proceed as follows:

1. Bend the top and bottom edges of the mounting base at the perforations until they break off. (See Figure 3.)

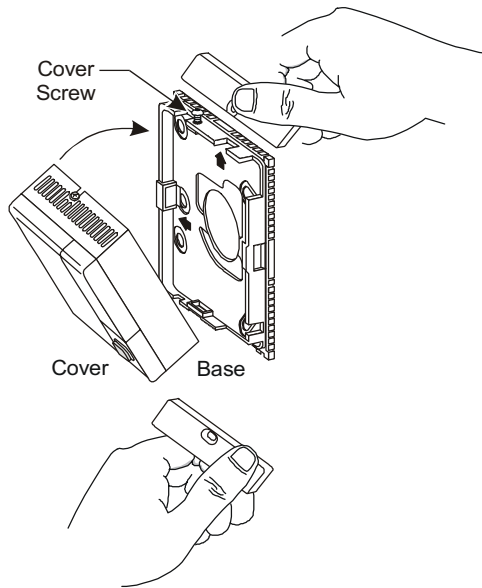

Figure 3: Removing the Breakaway Tabs

2. Drill a 1-3/8 in. (35 mm) hole in the surface where the sensor will be mounted, and pull the wiring through the drilled hole.

IMPORTANT: Seal the drilled hole or use an ACC-INSL-1 Foam Pad Kit to help reduce drafts entering the unit. Drafts could result in false temperature readings.

3. Mark the location of the two mounting screws, and drill the holes.
4. Insert the spring clips on each side of the drilled 1-3/8 in. (35 mm) hole, and use the spacers, if needed, as shown in Figure 4. Do not use the spacers for 5/8 in. (16 mm) drywall.

Note: For replacement spring clips, spacers, and screws, order the ACC-DWCLIP-0 Drywall Clip Mounting Kit.

5. Pull the wiring through the sensor base.
6. Center the two holes in the base over the two drilled holes, and fasten the base to the drywall using the No. 6 screws provided.
7. Place the bottom edge of the cover against the bottom lip of the base, and rotate it up onto the base as shown in Figure 2.
8. Tighten the cover screw.

IMPORTANT: To prevent drywall damage, do not overtighten the screws.

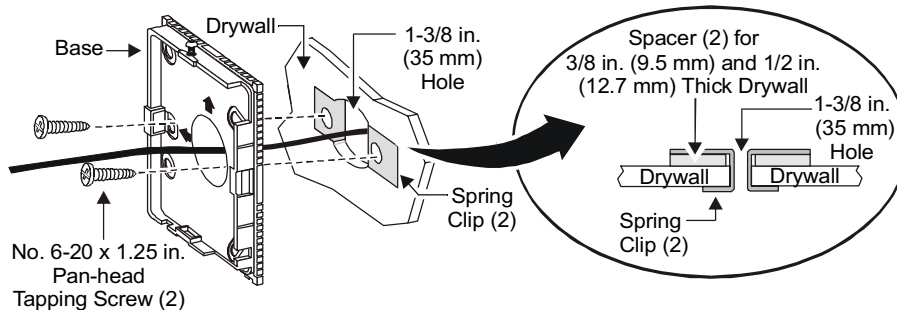

Figure 4: Surface Mounting to Drywall

**JOHNSON
CONTROLS**

Controls Group
507 E. Michigan Street
P.O. Box 423
Milwaukee, WI 53201

Published in U.S.A.
www.johnsoncontrols.com